

# STTC-SERIES

## SAFE T™ TORQUE CHECKER

Digital hydraulic torque wrench measurement system.  
Accurate performance testing for all Enerpac torque wrench products.



**ENERPAC** 

▼ STTC2000 Safe T™ Torque Checker



**Quick, simple and accurate mobile torque system safety testing device**



**Applications**

All bolted joints from 144 Ft.lbs up to 16.100 Ft.lbs (195 - 21.800 Nm).

- All Enerpac torque wrenches up to the maximum capacity of the Torque Checker. Also for other brands that fit the envelope of the Torque Checker.
- Oil & Gas flanges,
- Tower Crane installation,
- Bigger machine installation/assembly,
- Wind Tower installation etc.

**Industries:**

- Oil & Gas, Petrochemical,
- Wind Power Generation,
- Marine,
- Manufacturing,
- Mining, Rail and more.

**Safety & Accuracy**

- Durable mobile testing device for Enerpac hydraulic torque wrench systems
- Delivering ultimate on site accuracy, testing the entire wrench, pump and hose system to be used on the job
- Consistent and repeatable  $\pm 1\%$  accurate range.

**Durability**

- Durable splash-proof keypad and display for those harsh working environments
- Impact-resistant composite carry case.

**Simplicity**

- Allows the user to validate & test the exact system (torque wrench, pump, hose, etc.) to give a digital read out in Ft.lbs or Nm
- Easy to operate: power up and start testing
- Transportable: all in one compact carry case, ideal for use on the road with its durable internal 3,6 V-2,2 Ah Lithium-ion battery.

**Versatility**

- Can test all Enerpac S, W, RSL, HMT and DSX-Series wrenches of both square drive and hexagon cassettes up to 16.100 Ft.lbs (21.800 Nm)
- Hexagon Reducers or Square Drive Sockets to be bought separately.

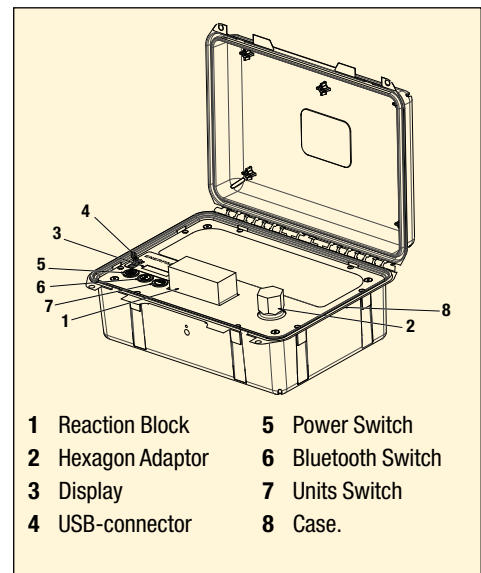

Hexagon Reducer (nr. 9) must be bought separately: see selection tables on next page. ►

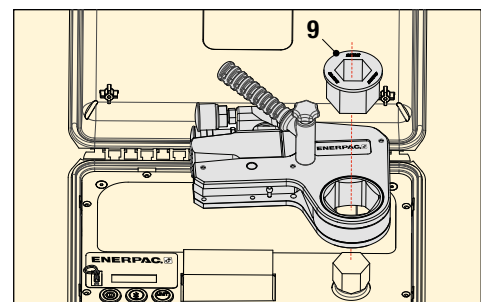

# Safe T™ Torque Checker



## Safe T™ Torque Checker

Mobile, compact safety device allows the end user to instantly validate the performance of the entire system to be used - not just the wrench only. Allows the user to test the system on-site and in situ.

The user can validate and test the exact torque system (wrench, pump, hose, etc) to give an accurate digital read out.

### Safety

The user can verify if the torque system is safe to operate, functioning correctly and within the desired safety parameters.

## Unique from Enerpac

No need to wait for annual calibration tests to be confident in the performance and safety of your equipment. The Safe T Torque Checker equipment can be validated in seconds, saving time and money.

### Hexagon Reducers

The W-Series Hexagon Reducers from the tables below, can be used with all W, RLP and HLP-Series hexagon cassettes.

## STTC Series



Max. Testing Output:

**16.100 Ft.lbs (21.800 Nm)**

Accuracy:

**± 1%**

Battery:

**3,6 V Lithium-ion**

For use with STTC2000		
Hexagon Size	Cassette Model Number	Hexagon Reducer to 1 1/16" (30 mm) Model Nr.
(inch)   (mm)		
1 1/16	-	W2101X -
1 1/8	-	W2102X -
1 3/16	<b>30</b>	<b>W2103X *</b>
1 1/4	32	W2104X **
1 1/2	-	W2105X **
1 5/8	-	W2106X <b>W2106R103D</b>
1 3/4	36	W2107X <b>W2107R103D</b>
1 1/2	38	W2108X <b>W2108R103</b>
1 9/16	-	W2109X <b>W2109R103</b>
1 5/8	41	W2110X <b>W2110R103</b>
1 11/16	-	W2111X <b>W2111R103</b>
1 3/4	-	W2112X <b>W2112R103</b>
1 13/16	46	W2113X <b>W2113R103</b>
1 7/8	-	W2114X <b>W2114R103</b>
1 15/16	-	W2115X <b>W2115R103</b>
2	50	W2200X <b>W2200R103</b>
2 1/16	-	W2201X <b>W2201R103</b>
2 1/8	-	W2202X <b>W2202R103</b>
2 1/4	55	W2203X <b>W2203R103</b>
2 1/2	-	W2204X <b>W2204R103</b>
2 5/8	-	W2205X <b>W2205R103</b>
2 3/4	60	W2206X <b>W2206R103</b>

For use with STTC4000		
Hexagon Size	Cassette Model Number	Hexagon Reducer to 1 1/16" (36 mm) Model Nr.
(inch)   (mm)		
1 5/16	-	W4105X -
1 3/8	-	W4106X -
1 7/16	<b>36</b>	<b>W4107X *</b>
1 1/2	-	W4108X **
1 9/16	-	W4109X **
1 5/8	41	W4110X <b>W4110R107</b>
1 11/16	-	W4111X <b>W4111R107</b>
1 3/4	-	W4112X <b>W4112R107</b>
1 13/16	46	W4113X <b>W4113R107</b>
1 7/8	-	W4114X <b>W4114R107</b>
1 15/16	-	W4115X <b>W4115R107</b>
2	50	W4200X <b>W4200R107</b>
2 1/16	-	W4201X <b>W4201R107</b>
2 1/8	-	W4202X <b>W4202R107</b>
2 1/4	55	W4203X <b>W4203R107</b>
2 1/2	-	W4204X <b>W4204R107</b>
2 5/8	-	W4205X <b>W4205R107</b>
2 3/4	60	W4206X <b>W4206R107</b>
2 7/8	-	W4207X <b>W4207R107</b>
2 11/16	-	W4208X <b>W4208R107</b>
2 1/2	-	W4209X <b>W4209R107</b>
2 5/8	-	W4210X <b>W4210R107</b>
2 11/16	-	W4211X <b>W4211R107</b>
2 3/4	70	W4212X <b>W4212R107</b>
2 13/16	-	W4213X <b>W4213R107</b>
2 7/8	-	W4214X <b>W4214R107</b>
2 15/16	75	W4215X <b>W4215R107</b>
3	-	W4300X <b>W4300R107</b>
3 1/16	-	W4301X <b>W4301R107</b>
3 1/8	80	W4302X <b>W4302R107</b>
3 1/4	-	W4303X <b>W4303R107</b>
3 1/2	-	W4304X <b>W4304R107</b>
3 5/8	-	W4305X <b>W4305R107</b>
3 3/4	-	W4306X <b>W4306R107</b>
-	85	W4085MX <b>W4085MR107</b>

For use with STTC8000		
Hexagon Size	Cassette Model Number	Hexagon Reducer to 2 inch (50 mm) Model Nr.
(inch)   (mm)		
1 7/8	-	W8114X -
1 15/16	-	W8115X -
<b>2</b>	<b>50</b>	<b>W8200X *</b>
2 1/16	-	W8201X **
2 1/8	-	W8202X **
2 1/4	55	W8203X <b>W8203R200</b>
2 1/2	-	W8204X <b>W8204R200</b>
2 5/8	-	W8205X <b>W8205R200</b>
2 3/4	60	W8206X <b>W8206R200D</b>
2 7/8	-	W8207X <b>W8207R200</b>
2 1/2	-	W8208X <b>W8208R200</b>
2 9/16	65	W8209X <b>W8209R200</b>
2 5/8	-	W8210X <b>W8210R200</b>
2 11/16	-	W8211X <b>W8211R200</b>
2 3/4	70	W8212X <b>W8212R200</b>
2 13/16	-	W8213X <b>W8213R200</b>
2 7/8	-	W8214X <b>W8214R200</b>
2 15/16	75	W8215X <b>W8215R200</b>
3	-	W8300X <b>W8300R200</b>
3 1/16	-	W8301X <b>W8301R200</b>
3 1/8	80	W8302X <b>W8302R200</b>
3 1/4	-	W8303X <b>W8303R200</b>
3 1/2	-	W8304X <b>W8304R200</b>
3 5/8	-	W8305X <b>W8305R200</b>
-	85	W8085MX <b>W8085MR200</b>
3 3/8	-	W8306X <b>W8306R200</b>
3 1/2	-	W8307X <b>W8307R200</b>
3 1/2	-	W8308X <b>W8308R200</b>
-	90	W8090MX <b>W8090MR200</b>
3 9/16	-	W8309X <b>W8309R200</b>
3 5/8	-	W8310X <b>W8310R200</b>
3 11/16	-	W8311X <b>W8311R200</b>
3 3/4	95	W8312X <b>W8312R200</b>
3 13/16	-	W8313X <b>W8313R200</b>
3 7/8	-	W8314X <b>W8314R200</b>
3 15/16	100	W8315X <b>W8315R200</b>
4	-	W8400X <b>W8400R200</b>
4 1/16	-	W8401X <b>W8401R200</b>
4 1/8	105	W8402X <b>W8402R200</b>

For use with STTC15000		
Hexagon Size	Cassette Model Number	Hexagon Reducer to 2 5/8 inch Model Nr.
(inch)   (mm)		
2 7/16	-	W15207X -
2 1/2	-	W15208X -
2 9/16	65	W15209X -
2 5/8	-	<b>W15210X *</b>
2 11/16	-	W15211X **
2 3/4	70	W15212X **
2 13/16	-	W15213X **
2 7/8	-	W15214X <b>W15214R210</b>
2 15/16	75	W15215X <b>W15215R210</b>
3	-	W15300X <b>W15300R210</b>
3 1/16	-	W15301X <b>W15301R210</b>
3 1/8	80	W15302X <b>W15302R210</b>
3 1/4	-	W15303X <b>W15303R210</b>
3 1/2	-	W15304X <b>W15304R210</b>
3 5/8	-	W15305X <b>W15305R210</b>
-	85	W15085MX <b>W15085MR210</b>
3 3/8	-	W15306X <b>W15306R210</b>
3 1/2	-	W15307X <b>W15307R210</b>
3 1/2	-	W15308X <b>W15308R210</b>
-	90	W15090MX <b>W15090MR210</b>
3 9/16	-	W15309X <b>W15309R210</b>
3 5/8	-	W15310X <b>W15310R210</b>
3 11/16	-	W15311X <b>W15311R210</b>
3 3/4	95	W15312X <b>W15312R210</b>
3 13/16	-	W15313X <b>W15313R210</b>
3 7/8	-	W15314X <b>W15314R210</b>
3 15/16	100	W15315X <b>W15315R210</b>
4	-	W15400X <b>W15400R210</b>
4 1/16	-	W15401X <b>W15401R210</b>
4 1/8	105	W15402X <b>W15402R210</b>
4 1/4	-	W15403X <b>W15403R210</b>
4 1/4	-	W15404X <b>W15404R210</b>
4 5/16	110	W15405X <b>W15405R210</b>
4 3/8	-	W15406X <b>W15406R210</b>
4 7/16	-	W15407X <b>W15407R210</b>
4 1/2	-	W15408X <b>W15408R210</b>
-	115	W15115MX <b>W15115MR210</b>
4 9/16	-	W15409X <b>W15409R210</b>
4 5/8	-	W15410X <b>W15410R210</b>



### Hexagon Reducers:

Must be bought separately. Can be used with all W, RLP and HLP-Series

hexagon cassettes.

\* Standard hexagon size of adaptor included with STTC-model

\*\* Requires special reaction block.

Nominal Measurable Torque Output		Model Number <sup>1)</sup>	Hexagon Adaptor included		Carry Case Size L x B x H		Sockets to be used with Square Drive Wrenches <sup>2)</sup>	Hexagon Cassette fits Adaptor. For other hexagon sizes, see table above with Hexagon Reducers sizes <sup>2)</sup>		
(Ft.lbs)	(Nm)		(inch)	(mm)	(mm)			(kg)	W-Series	RSL-Series
2140	2900	<b>STTC 2000</b>	1 3/16	30	414 x 328 x 328	6	BSH7530	W2103X	RLP1103	HLP1103
4383	5950	<b>STTC 4000</b>	1 7/16	36	414 x 328 x 328	8	BSH1036	W4107X	RLP3107	HLP3107
8893	12.000	<b>STTC 8000</b>	2	50	624 x 498 x 168	19	BSH1550	W8200X	RLP5200	HLP3200
16.100	21.800	<b>STTC 15000</b>	2 5/8	-	624 x 498 x 168	26	BSH15263	W15210X	RLP8210	HLP7210

<sup>1)</sup> With 3,6 V-2,2 Ah Lithium-ion battery.

<sup>2)</sup> Square drive sockets, hexagon cassettes and hexagon reducers must be bought separately.



# THE RIGHT TOOL MAKES ALL THE DIFFERENCE

Enerpac bolting tools are put to work under the most intense and demanding conditions. That's why we never compromise. So you can rely on quality and precision every time for your controlled tightening and joint integrity applications.

As a global leader in high-pressure hydraulic tools, controlled force products and solutions for precision positioning of heavy loads, Enerpac products have moved and maintained some of the largest structures on earth. They are the industry standard in aerospace, infrastructure, manufacturing, mining, oil & gas, power generation and much more.

ELITE TOOLS. FOR ELITE PROFESSIONALS.

## Controlled Tightening and Loosening



S-, W-, RSL-, DSX and HMT-Series Hydraulic Torque Wrenches



STTL- Safe T™ Torque Lock



STTC- Safe T™ Torque Checker



Manual & Pneumatic Multipliers



Cordless Torque Pumps



Electric Torque Pumps



Pneumatic Torque Pumps

## Tensioning Tools



Power Generation Bolt Tensioners



HydraMax, General Purpose and Aquajack® Subsea Tensioners



Electric Tensioning Pumps



Pneumatic Tensioning Pumps



High-Pressure Hand Pumps

## Joint Assembly & Joint Separation



Hydraulic Nut Splitters



Flange Alignment Tools



Flange Face Tool



Flange Spreaders



Flange Puller Sets



Valve Change-Out Tool Sets



[www.enerpac.com](http://www.enerpac.com)